

| 版本 Edition | 变更内容 Description of the change |
|------------|--------------------------------|
| B          | 电磁参数更新                         |
| C          | 外形图模板变更                        |

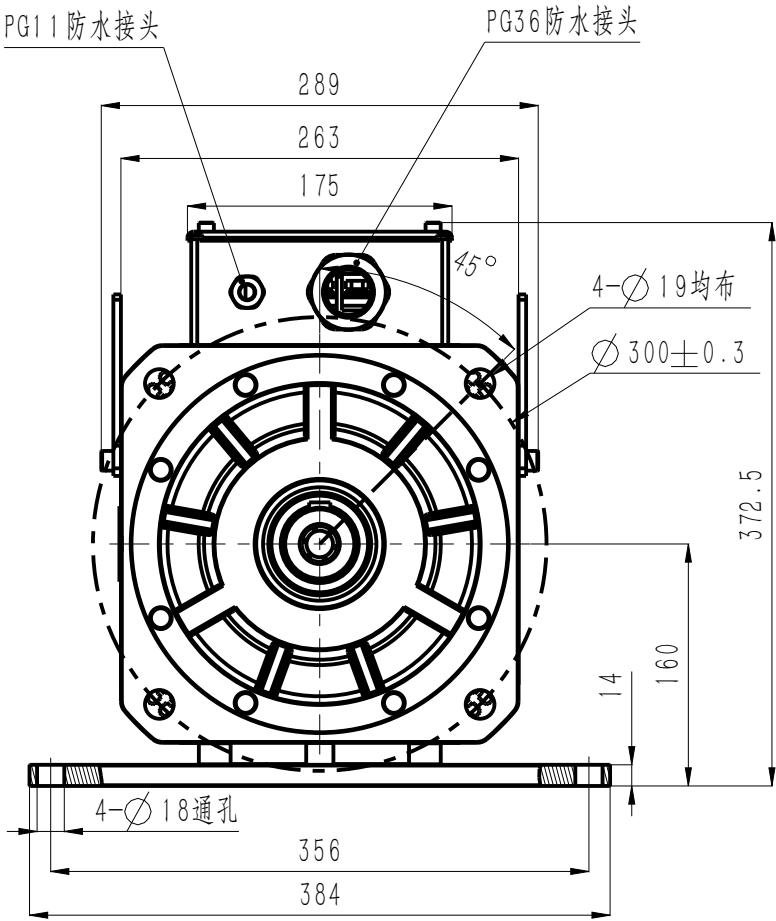

电机技术参数 Motor parameters

|   |   |                    |
|---|---|--------------------|
| 额定电压 Rated voltage                      | 380   | V AC               |
| 额定功率 Rated power                        | 47.1  | kW                 |
| 额定扭矩 Rated torque                       | 225   | N·m                |
| 额定电流 Rated current                      | 86.3  | Arms               |
| 峰值扭矩(1000rpm) Peak torque               | 563   | N·m                |
| 峰值电流(1000rpm) Peak current              | 168.7   | Arms               |
| 峰值扭矩(2000rpm) Peak torque               | 400   | N·m                |
| 峰值电流(2000rpm) Peak current              | 156.3   | Arms               |
| 峰值扭矩(3000rpm) Peak torque               | 275   | N·m                |
| 峰值电流(3000rpm) Peak current              | 156.3   | Arms               |
| 额定转速 Rated speed                        | 2000  | rpm                |
| 峰值转速 Maximum speed                      | 3000  | rpm                |
| 扭矩系数 Torque constant                    | 2.61  | N·m/Arms           |
| 反电势常数 Back EMF constant                 | 210.9   | V/krpm             |
| 线电阻 line resistance                     | 0.115   | Ω                  |
| 线电感 line inductance                     | 4.36  | mH                 |
| 转动惯量 Moment of inertia                  | 406   | kg·cm <sup>2</sup> |
| 轴向允许载荷 Axial allowable load             | 500   | N                  |
| 径向允许载荷 Radial allowable load            | 1500  | N                  |
| 极对数 Number of pole pairs                | 4   | 对                  |
| IP防护等级 Ingress Protection Rating        | IP54  |                    |
| 绝缘等级 Insulation class                   | F   |                    |
| 绝缘电阻 Insulation resistance              | >100MΩ DC500V                                   |                    |
| 电机重量 Motor weight                       | 115   | kg                 |
| 工作温度 Operating temperature              | -20℃~40℃  |                    |
| 工作湿度 Operating humidity                 | 20%~80%<br>(不结露 Non-dewfall)                    |                    |
| 推荐安装海拔<br>Recommend installing altitude | <1000m(1km以上降额使用)<br>(Derate for use above 1km) |                    |

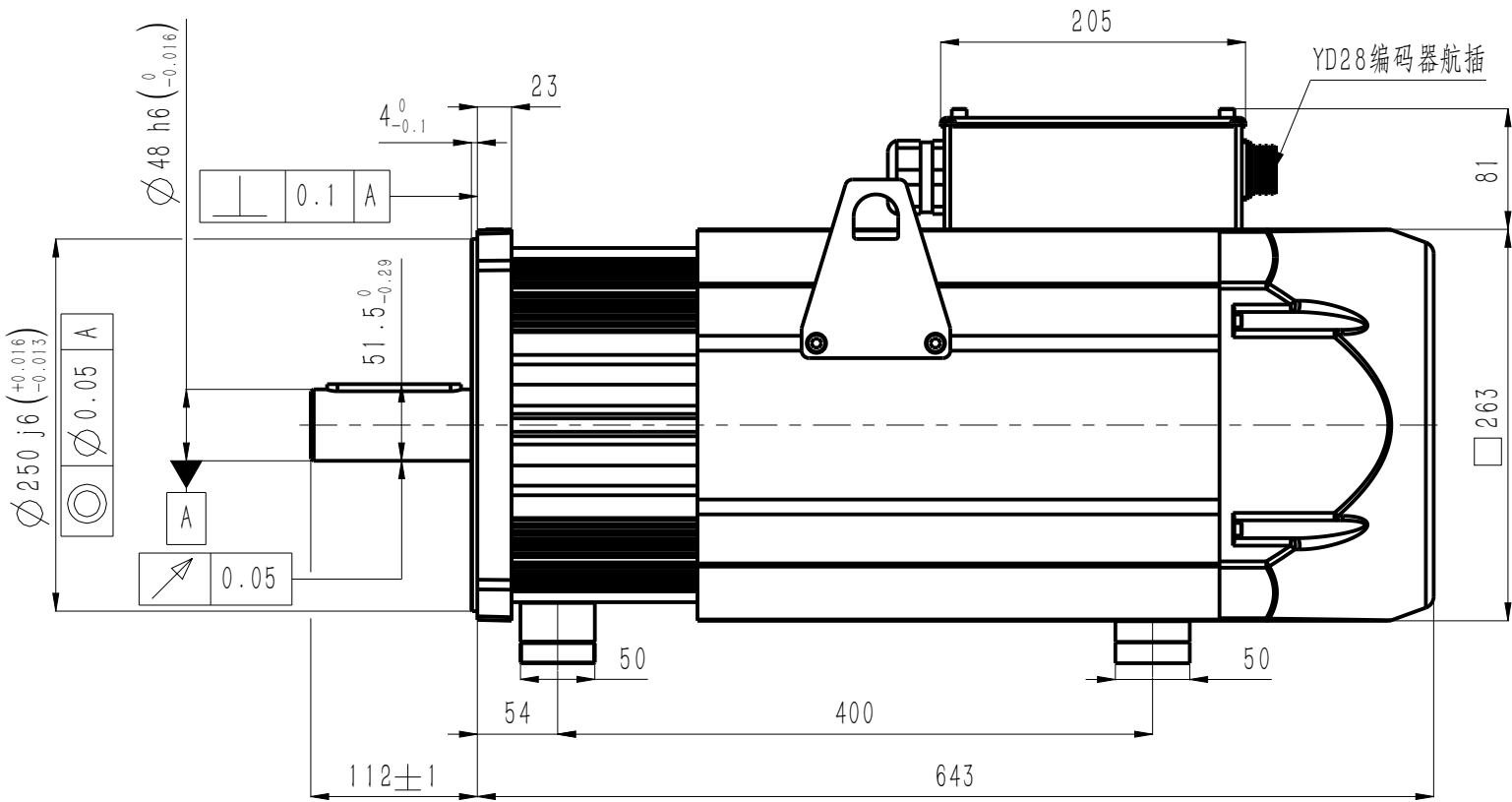
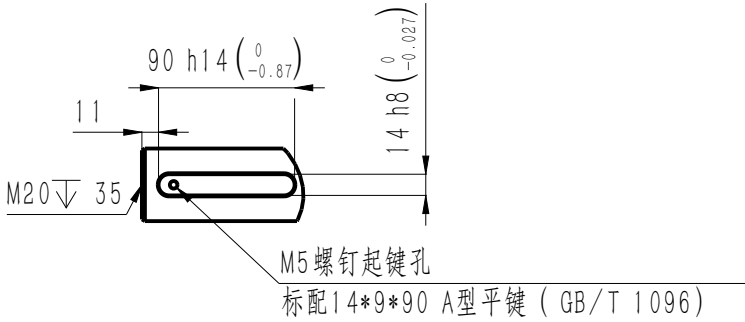

引线定义  
Wiring definition

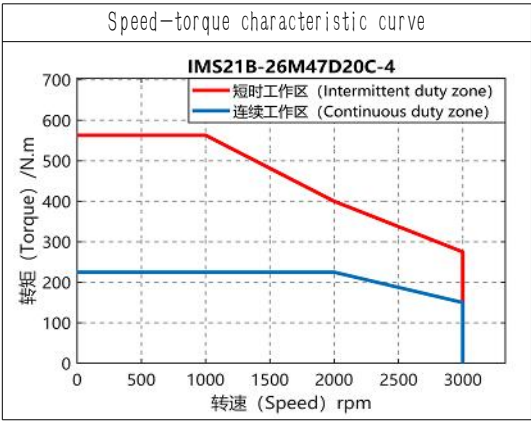
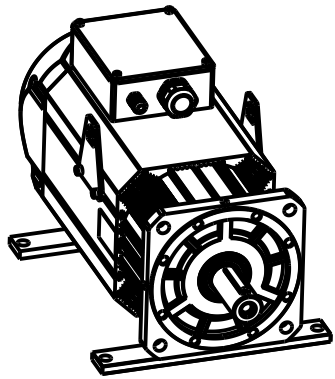
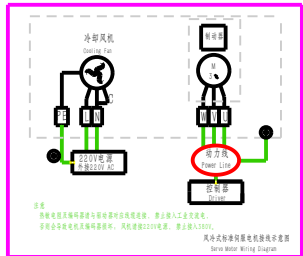
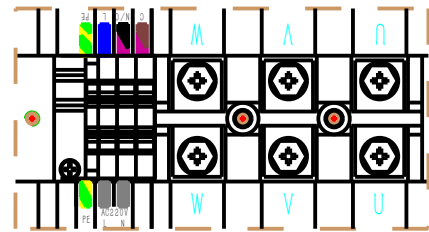

| SN  | 料号 P/N      | 整机型号 Model and Specification | 编码器 Encoder |
|-----|-------------|------------------------------|-------------|
| 1   | 11101-01855 | IMS21B-26M47D20C-4-R7F-A     | 12位旋变       |
| 2   | 11101-01879 | IMS21B-26M47D20C-4-P9F-A     | 23位多圈光编     |
| C   | 修改          | /                            | 2026-2-12   |
| B   | 修改          | /                            | 2026-1-20   |
| A   | 新归档         | /                            | 2025-12-17  |
| 版本  | 更改方式        | 更改人                          | 日期          |
| 设计  | /           | 料号                           | /           |
| 校核  | /           | 图号                           | /           |
| 工艺  | /           | 重量                           | /           |
| 审核  | /           | 比例                           | 1:1         |
| 标准化 | /           | 第 1 页                        | 共 1 页       |
| 批准  | /           |                              |             |